

### 2011 Camaro A/B Street 6.2L

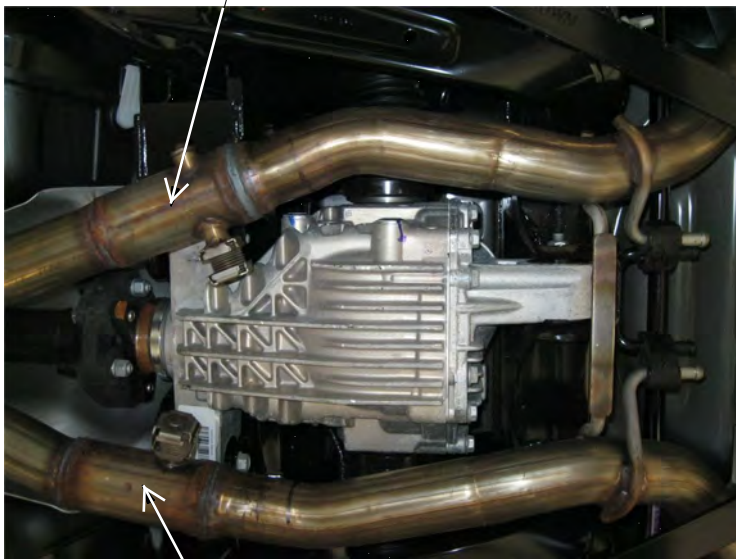
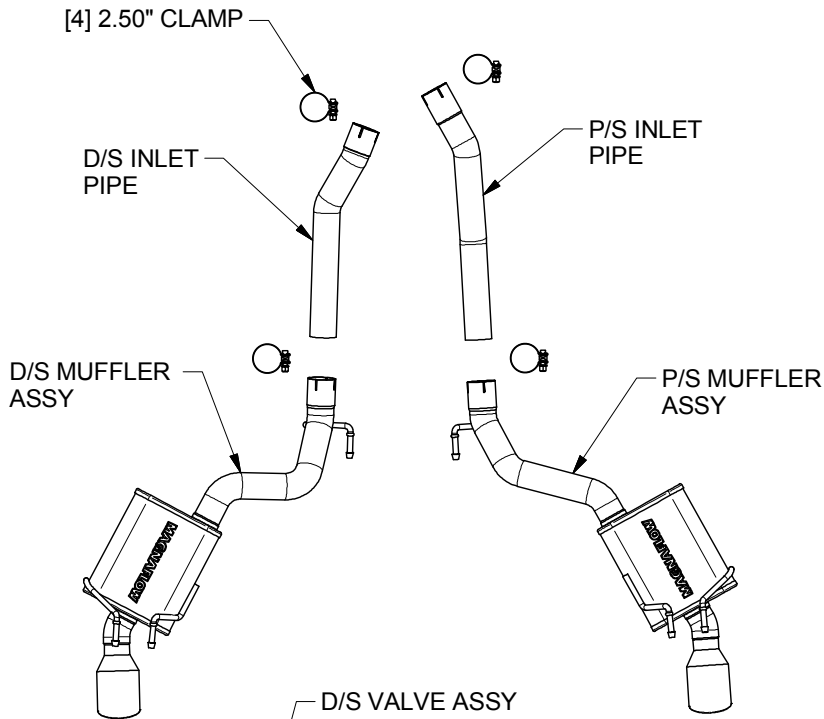

Fig.1

**Warning:** When working on, under, or around any vehicle exercise caution. Please allow the vehicle's exhaust system to cool before removal, as exhaust system temperatures may cause severe burns. If working without a lift, always consult vehicle manual for correct lifting specifications. Always wear safety glasses and ensure a safe work area. Serious injury or death could occur if safety measures are not followed.

-Carefully read all instructions before installation-

**Step 1:** With all components mounted loosely, adjust the system for overall aesthetics and clearance of frame & bodywork. (MAGNAFLOW recommends at least 1/2" of clearance between the exhaust system and any body panels to prevent heat-related body damage or fire.)

**Step 2:** You will need to cut the OEM exhaust system to remove it and to allow for the installation of the new exhaust. Measure and cut 1.00" forward of the Valve Assembly weld (shown in Fig.1) on the passenger side pipe, and 4.00" on the driver side pipe. Carefully remove the system from the vehicle making sure to retain all mounting hardware as it will be needed to install your new MAGNAFLOW system.

**Step 3:** Begin installing the new system. Attach the two Inlet Pipes to the cut portion of the OEM system. Use the supplied clamps to secure. Slip both Muffler Assemblies over the Inlet Pipes using the supplied clamps to secure. Make sure you locate the hangers in the existing rubber insulators.

**Step 4:** Once a final position has been chosen for the new system, evenly tighten all fasteners from front to rear. The supplied band clamps must be VERY tight to properly align the pipes and prevent leaks (Approximately 40ft-lbs). U-bolt clamps should be tightened to approximately 30-35ft-lbs. Inspect all fasteners after 25-50 miles of operation and retighten if necessary.

**\*\* Magnaflow Performance Exhaust recommends professional installation on all their products**