

1975'-1981' Chevrolet Corvette 5.7L

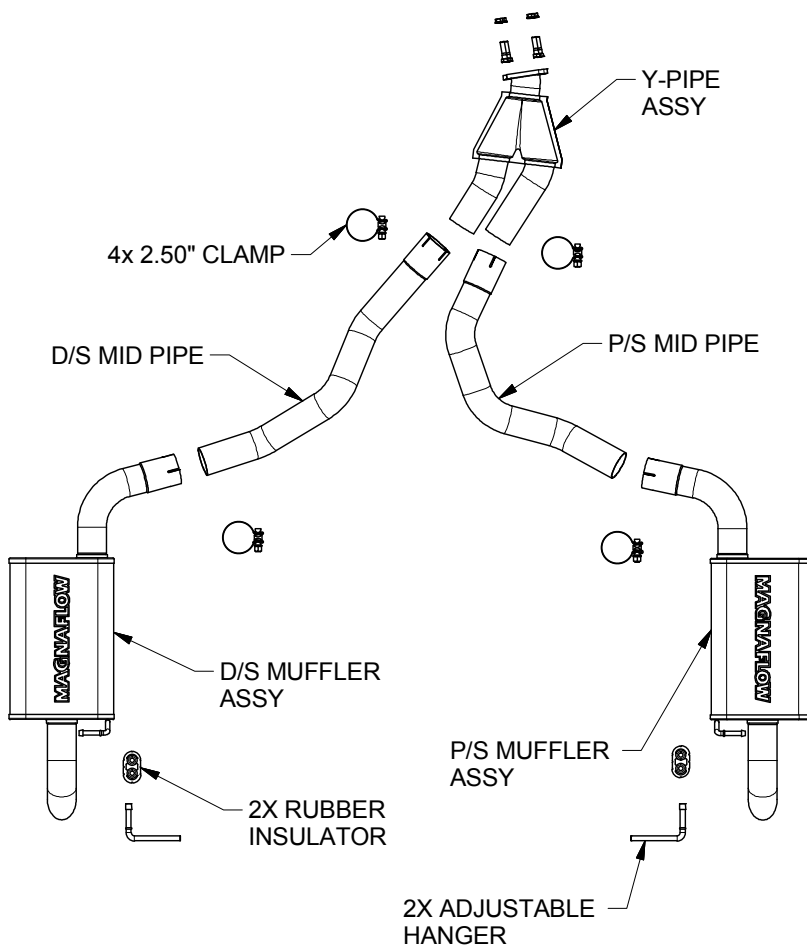

Warning: When working on, under, or around any vehicle exercise caution. Please allow the vehicle's exhaust system to cool before removal, as exhaust system temperatures may cause severe burns. If working without a lift, always consult vehicle manual for correct lifting specifications. Always wear safety glasses and ensure a safe work area. Serious injury or death could occur if safety measures are not followed.

Step 1: To begin the removal of your OEM exhaust system, unbolt the pipes from the mounting bracket located behind the cross-member (mounting bracket will no longer be used). Unfasten four bolt flange from manifold & the tail pipe/muffler assemblies from the OEM rubber insulators and remove.

Step 2: Install your new MAGNAFLOW system by mounting the supplied adjustable hangers to the rear cross member with the supplied fasteners (use these hangers to set the correct orientation for clearance and aesthetics). Next, attach the Y-pipe assembly at the flange junction to the rear of the converter with supplied hardware. Next, slip the D/S & P/S mid pipes onto the Y-pipe assembly and secure with supplied 2.50" clamp. Finish by installing the muffler assembly in a similar fashion. Leave all hardware loose until the system is fully installed. Locate all hangers into rubber insulators.

Step 3: With all components mounted loosely, adjust the system for overall aesthetics and clearance of frame & bodywork. (MAGNAFLOW recommends at least 1/2" of clearance between the exhaust system and any body panels to prevent heat-related body damage or fire.)

Step 4: Once a final position has been chosen for the new system, evenly tighten all fasteners from front to rear. The supplied band clamps must be VERY tight to properly align the pipes and prevent leaks (Approximately 40ft-lbs). Inspect all fasteners after 25-50 miles of operation and retighten if necessary.

**** Magnaflow Performance Exhaust recommends professional installation on all their products**